



INSTRUCTIONS

Product: GEM Electric Motorcars

Models: All

Subject: Instructions for installing Stereo Accessory

Estimated Completion Time: .75 Hours

Parts: See Page # 7

REQUIRED TOOLS & SUPPLIES:

- | | |
|----------------------------|---|
| (1) 3/8" Drive Ratchet | (1) Wire Cutter |
| (1) 3/8" Socket | (1) Needle Nose Pliers |
| (1) Small felt tip Marker | (1) Tape Measure |
| (1) Drill | (1) 6 Ft. of 18 Ga. Me-
chanics Wire |
| (1) Center Punch | (2) Spring loaded Adjust-
able Shower Curtain Rods |
| (1) Ø 1/4" Drill Bit | (1) Tube of Epoxy |
| (1) Ø 3/8" Drill Bit | (1) Epoxy Gun |
| (6") Masking Tape | |
| (1) Phillips Screwdriver | |
| (1) Small Flat Screwdriver | |
| (1) Med. Flat Screwdriver | |
| (1 Pair) Safety Glasses | |

WARNING!

To prevent personal injury or property damage: Switch the 72-volt Master Disconnect to "OFF", be sure the ignition switch is always in the "OFF" position and that the "KEY" is removed. Set the parking brake, then make sure that all moving parts have come to a complete stop before servicing, adjusting, or repairing.

WARNING!

HIGH VOLTAGE



You could be seriously or fatally injured by electric shock if you attempt to open, repair, test, inspect or adjust. Only qualified technicians should open and service. Consult service manual.

The following instructions are for installing the Stereo accessory to all models of GEM cars.
To install the stereo, proceed as follows.

1. Remove bench seat cushion (rear bench seat cushion for 4 passenger vehicles) to access the Master Disconnect switch. Switch master disconnect off. (See Fig. # 1.

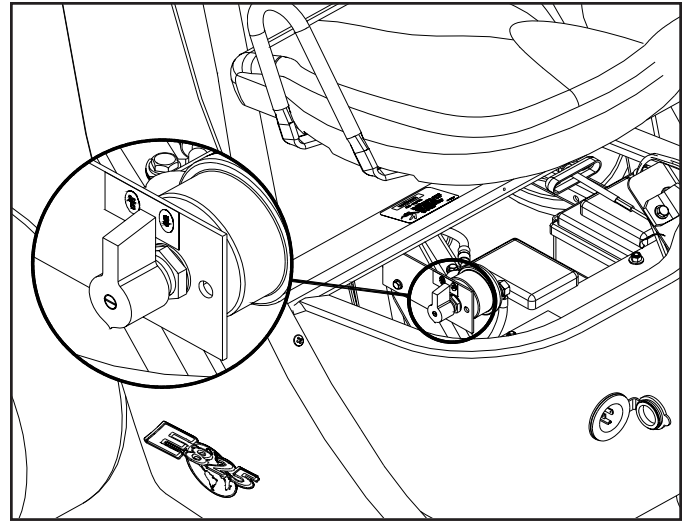

Fig. # 1 Switch master disconnect off

2. Remove the Qty. two (2) 1" Dia. Hood Knobs securing the hood. (See Fig # 2).

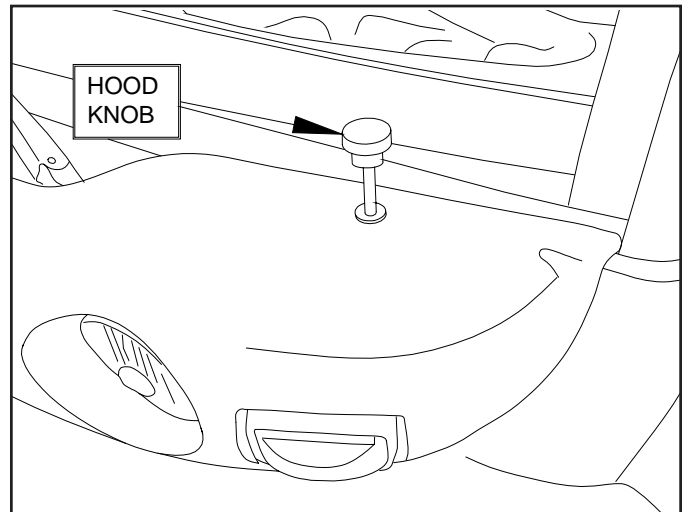

Fig. # 2 Loosen and remove hood knobs

3. Newer models only require for the latch to be unclasp. (See Fig # 3).

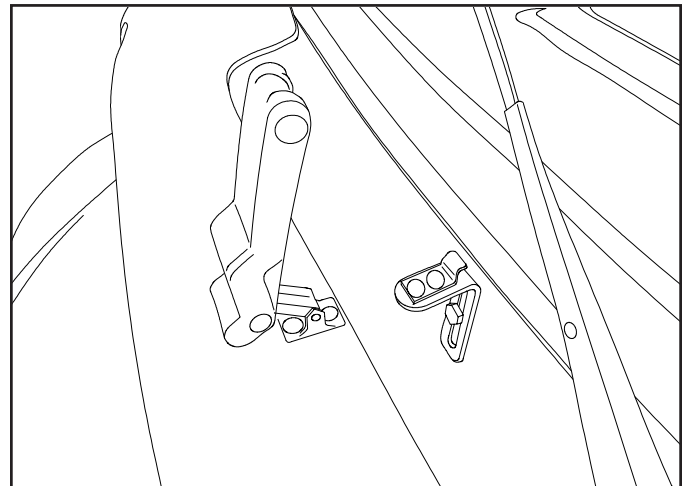

Fig. # 3 unclasp latch

4. Open the hood.

REMOVING THE DASH

5. Loosen the Qty. two (2) dash mount bolts securing the upper dash located on the front of the lower windshield support. (See Fig. # 4)

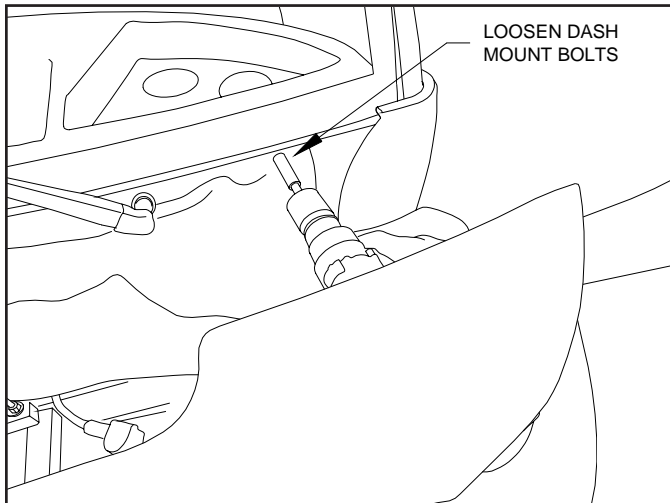

Fig. # 4 Loosen dash mount bolts

6. Remove upper dash. (See Fig. # 5)



Fig. # 5 Remove upper dash

7. Remove Qty. three (3) lower dash mounting bolts. (See Fig. # 6)

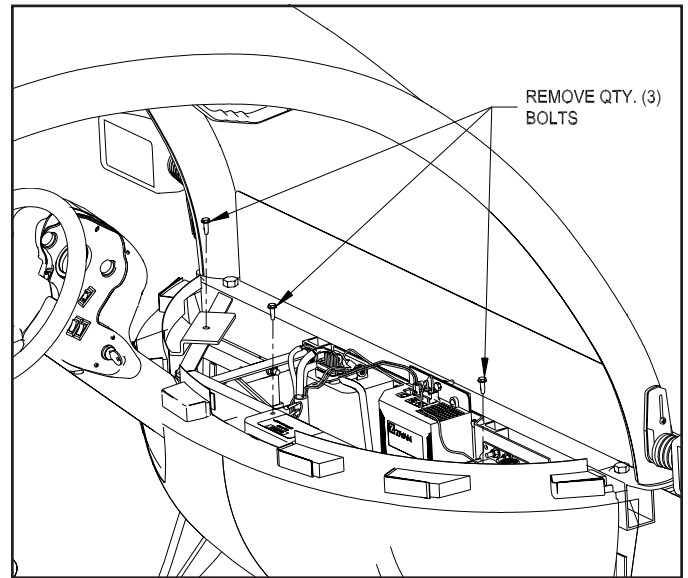

Fig. # 6 Remove lower dash mount bolts

REMOVING THE GRAB HANDLES

8. Remove grab handles from each side of vehicle. First remove the plastic caps with a small flat tip screwdriver. Then remove the screws securing the grab handles. (See Fig. # 6)



Fig. # 6 Remove grab handles

LOCATING THE STEREO CONSOLE

9. Locate the stereo console on the inside roof of vehicle.
10. Mark the hole locations for the wiring harness to be routed at the driver side of vehicle on the roof rail and stereo console. (See Fig. # 7, 8, 9 & 10)



Fig. # 7 Mark hole locations for wiring harness



Fig. # 9 Mark and drill Ø3/8" hole in roof rail 1/2" down from ceiling



Fig. # 10 and 3-1/4" from front window brace

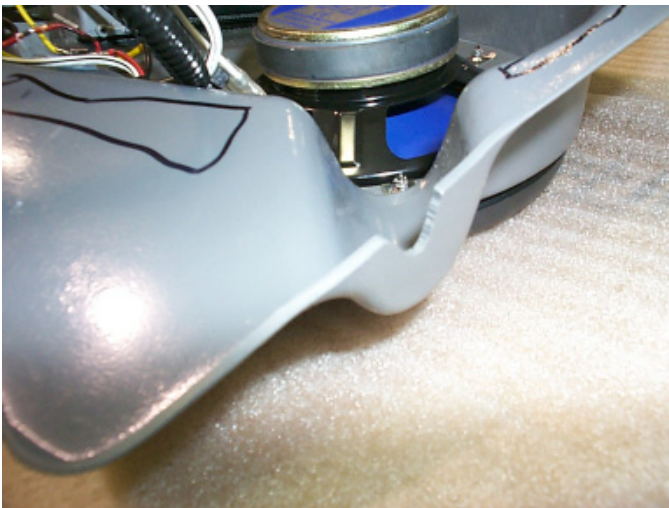

Fig. # 8 Align notch with hole to be drilled in roof rail

ROUTING WIRING HARNESS

11. Remove stereo console from roof. Drill holes to $\text{Ø}3/8$ " previously marked through one side of roof rail and console. Deburr holes after drilling.
12. Drill a $\text{Ø}3/8$ " hole at the lower inner corner of roof rail below dash.
13. Use a 6Ft. length of 18 Ga. mechanics wire to form a fish tape and insert in the bottom hole and out the top hole.



Fig. # 12 Drill lower hole in roof rail

14. Attach wiring harness to fish tape and pull down through bottom.
15. Dry fit the stereo console to roof to check for fit.
16. Apply epoxy to the stereo console at the locations shown in (Fig. # 13). Typically 3" long increment of epoxy and 3" to 4" center to center. Be sure to stay away from edge of console.

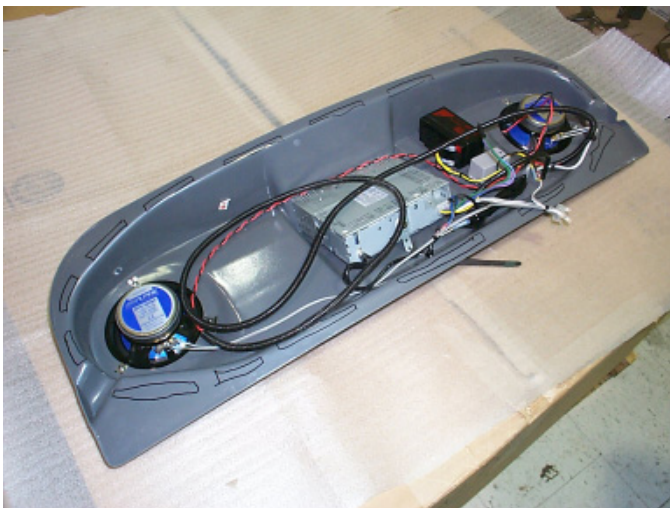

Fig. # 13 Apply epoxy to stereo console

17. Carefully fit console to roof and support by the spring loaded adjustable shower curtain rods. (See Fig. # 14)

IMPORTANT

Make sure console does not slip in out of position after mounted to roof of vehicle.



Fig. # 14 Drill lower hole in roof rail

WIRING

16. Route wiring harness along the same path as the existing wiring harness that leads to the circuit board and secure with tie straps.
17. Connect the **RED** wire to the circuit board marked **J9**. (See Wiring Diagram)
18. Connect the **Black** end of the wire to the circuit board marked **J8**.
19. Secure remaining wires with tie straps.

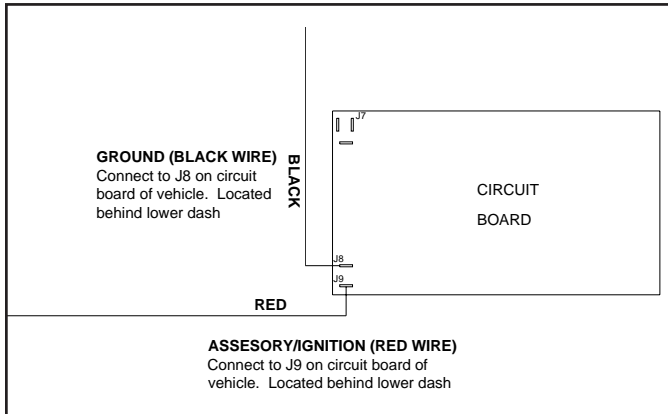

Fig. # 15 Wiring schematic

INSTALLING ANTENNA

26. Determine the exact location for the antenna to be installed. Clean the area with isopropyl alcohol, then remove adhesive backing and apply to window as show in (Fig. # 17).



Fig. # 15 Wiring schematic

RE-ASSEMBLY

31. Re-install grab handles to roof rail.
32. Install lower and upper dash in the reverse dis-assembly procedure.
33. Install safety decal to location shown in (Fig. # 19). Use P/N 0350-00549 for 2 passenger vehicles. Use P/N 0350-00548 for 4 passenger vehicles.
34. Close hood.
35. Turn master disconnect switch to the "ON" position.

NOTE: The stereo may stay on up to 40 seconds after the ignition is turned to the "OFF" position.



Fig. # 19 Stereo installation finished

IN PROCESS



Global Electric Motorcars, LLC

A DaimlerChrysler Company

Toll Free: 866.764.0616

Fax: 701.232.0600

e-mail: service@gemcar.com

Web Site: www.gemcar.com